

EAST SUSSEX COUNTY COUNCIL

**ROAD TRAFFIC REGULATION ACT 1984, ROAD TRAFFIC ACT 1991 &
TRAFFIC MANAGEMENT ACT 2004**

The East Sussex Lewes Town (Parking Places and Waiting and Loading Restriction) Traffic Regulation Order 2014 Amendment No.1 Order 2016

East Sussex County Council, in exercise of their powers under Sections 1(1), 2(1) to (4), 3(2), 4(2), 32, 35(1) and (3), 45, 49, 51, 52, 53 of, and Part IV of Schedule 9 to the Road Traffic Regulation Act 1984 ("the Act") as amended, the Road Traffic Act 1991 (as amended), Part 6 of the Traffic Management Act 2004, and of all other enabling powers and after consultation with the Chief Officer of Police in accordance with Part III of Schedule 9 to the Act hereby make the following Order:-

1. Commencement and citation

This Order may be cited as "The East Sussex Lewes Town (Parking Places and Waiting and Loading Restriction) Traffic Regulation Order 2014 Amendment No.1 Order 2016" and shall come into effect on 3rd October 2016.

2. When this Order comes into effect:

(a) The East Sussex Lewes Town (Parking Places and Waiting and Loading Restriction) Traffic Regulation Order 2014, as amended, shall have effect except as hereinafter contained.

(i) Part I – Preliminary, that the following definitions in the Interpretation section shall be amended as follows;

1 That the definition for "goods" shall be deleted and replaced with the following:

"goods" means any article not easily carried by hand or burden of any description and "delivering" and/or "collecting" in relation to any goods includes checking, loading or unloading the goods for the purposes of their delivery or collection;

(ii) Part II – Waiting and Loading restrictions and designation of Parking Places, that the following articles shall be amended as follows:

1 Article 3. (2) shall be deleted and the following shall be inserted:

3.	(2)	No person shall cause or permit any vehicle to wait in any road shown in the Order Plans as having a weight limit restriction if that vehicle exceeds the weight limit restriction except for so long as may be necessary for the purpose of delivering or collecting goods or for loading or unloading the vehicle at premises adjacent to the road.
----	-----	---

2 Article 4. (4) shall be deleted and the following shall be inserted:

4.	(4)	Each parking place referred to in the Order Plans as being Permit Holder or Pay and Display parking places may be used, subject to the provisions of this Order, for the leaving during the permitted hours of such vehicles of the class specified in paragraph (1) of this Article which display in the manner specified in Article 5(2) either a valid resident's, business or day permit or a valid ticket issued in respect of that vehicle under the provisions of this Order.
----	-----	--

3 Article 4. (11) shall be inserted as follows:

4.	(11)	Each parking place referred to in the Order Plans as being Time Limited parking places may be used, subject to the provisions of this Order, for the leaving during the permitted hours of such vehicles of the class specified in paragraph (1) of this Article.
----	------	---

(iii) Part III – Supplementary Provisions, that the following articles shall be amended as follows:

1 In the section for 'Contravention in a Parking Place and Penalty Charge', that Article 6. (h) shall be deleted and a new Article 6. (h) be inserted as follows:

6.	(h)	a vehicle exceeds the permitted length of stay for that parking place; or
----	-----	--

2 In the second section entitled 'Exemptions from the penalty charge', that this title shall be replaced and retitled as 'Issue of a Resident's Permit' and that Article 23 (1) shall be deleted and the following Article shall be inserted:

23.	(1)	<p>A resident who is the registered keeper of a vehicle of the class specified in Article 4(l) may apply to the Council or authorised agent for the issue of a resident's permit in respect of that vehicle and any such application shall be made on a form obtainable from the Council or authorised agent and shall include the particulars and information required by such form to be supplied and shall be accompanied by the remittance of the relevant charge specified in Schedule G2.</p> <p>Provided that, a resident may not apply to the Council or authorised agent for the issue of a resident's permit in any case where more than one other residents' permit has previously been issued to either that resident or any other resident in the same household and that permit remains valid or;</p> <p>if in the planning application process for the development of the premises of which the applicant for a permit is or will be a resident (hereafter "the Premises"), or if either as part of the process of the local planning authority considering whether prior approval under the Town and Country Planning (General Permitted Development) Order 1995 is required in respect of the Premises or in any document which specifies whether prior approval under the order is required in relation to the Premises, the local planning authority has and/or the Council in any consultation or other discussion with the planning authority has stated that no permit or a single permit will be issued in respect of the property.</p>
-----	-----	--

(iv) The Order Plans shall be amended as follows:

The map tiles below shall be revoked	The map tiles below shall be inserted
Overview	Overview Revision 1
	LJ102
LK104	LK104 Revision 1
LK107	LK107 Revision 1
LL104	LL104 Revision 1
LL105	LL105 Revision 1
LM103	LM103 Revision 1
LM104	LM104 Revision 1
LM108	LM108 Revision 1
LM109	LM109 Revision 1
LN105	LN105 Revision 1
LN106	LN106 Revision 1
LN107	LN107 Revision 1
LO105	LO105 Revision 1
LO106	LO106 Revision 1
LP102	LP102 Revision 1
LP105	LP105 Revision 1

LP107	LP107 Revision 1
LQ102	LQ102 Revision 1
LQ103	LQ103 Revision 1
	LS104

21921

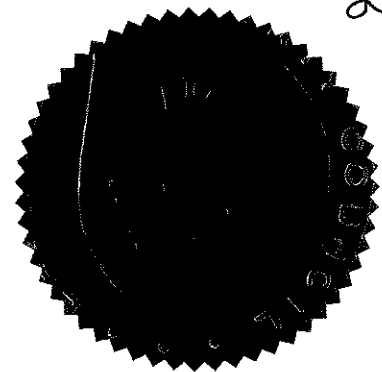

THE COMMON SEAL of EAST SUSSEX)
 COUNTY COUNCIL was affixed)
 hereto on the 23rd day of September two)
 thousand and sixteen in the presence of:-)

Authorised Signatory

H & T Ctte. 2.4.74 - para 4.2 joint report of Director of legal & Community Services & County Engineer - para 4.

**The East Sussex Lewes Town (Parking Places and Waiting and Loading Restriction)
Traffic Regulation Order 2014 Amendment No.1 Order 2016**

The Order Plans

Amendments

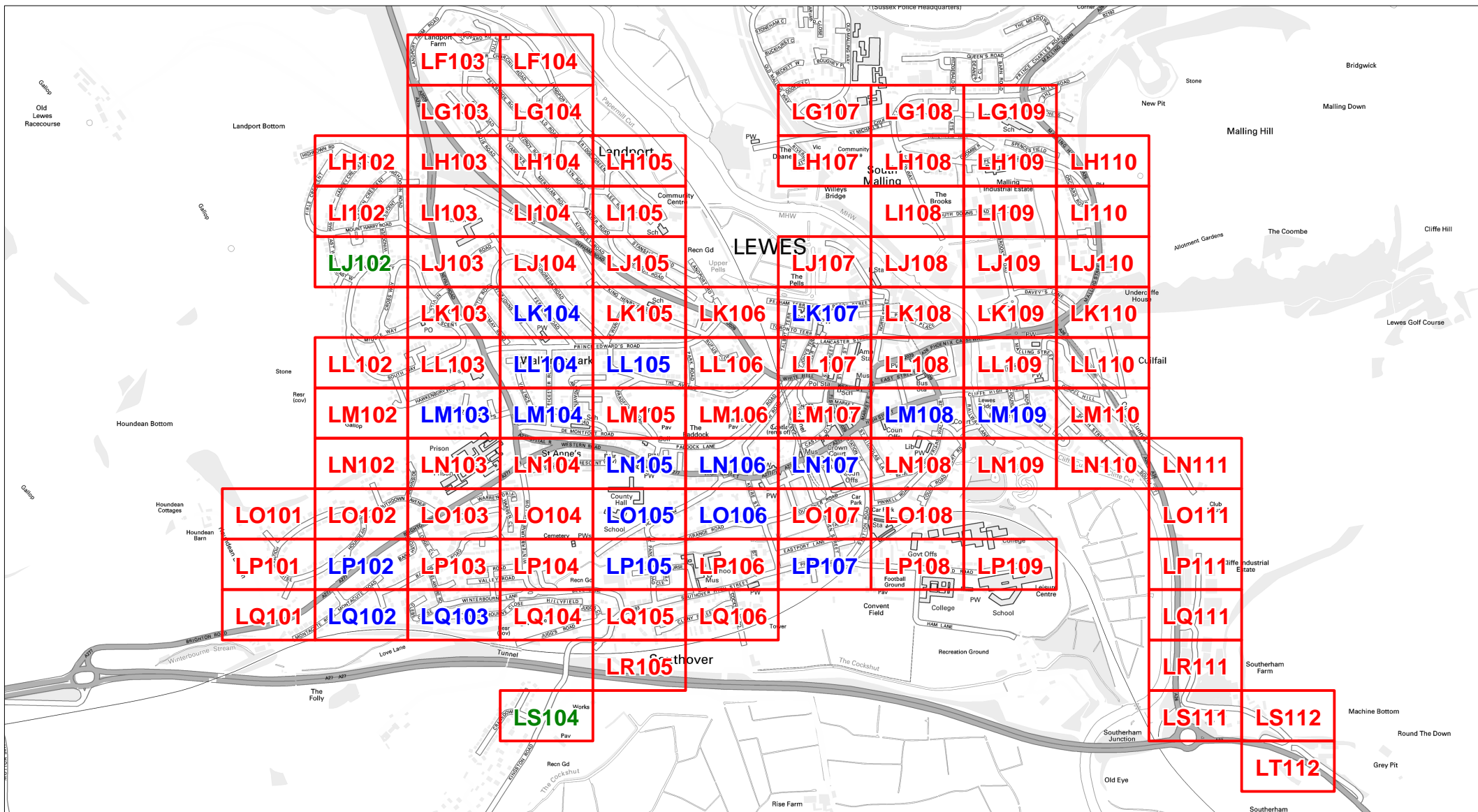

The East Sussex Lewes Town
(Parking Places and Waiting
and Loading Restrictions)
Traffic Regulation Order 2014
Amendment No.1 2016

Locations of Parking and Waiting Restrictions

- LR000 Existing Tile
- LR000 New Tile
- LR000 Revised Tile

© Crown copyright. All rights reserved
East Sussex County Council
Licence No. 100019601 2016



SCALE	1:16000
DATE	

Tile Ref: Overview Revision: 1

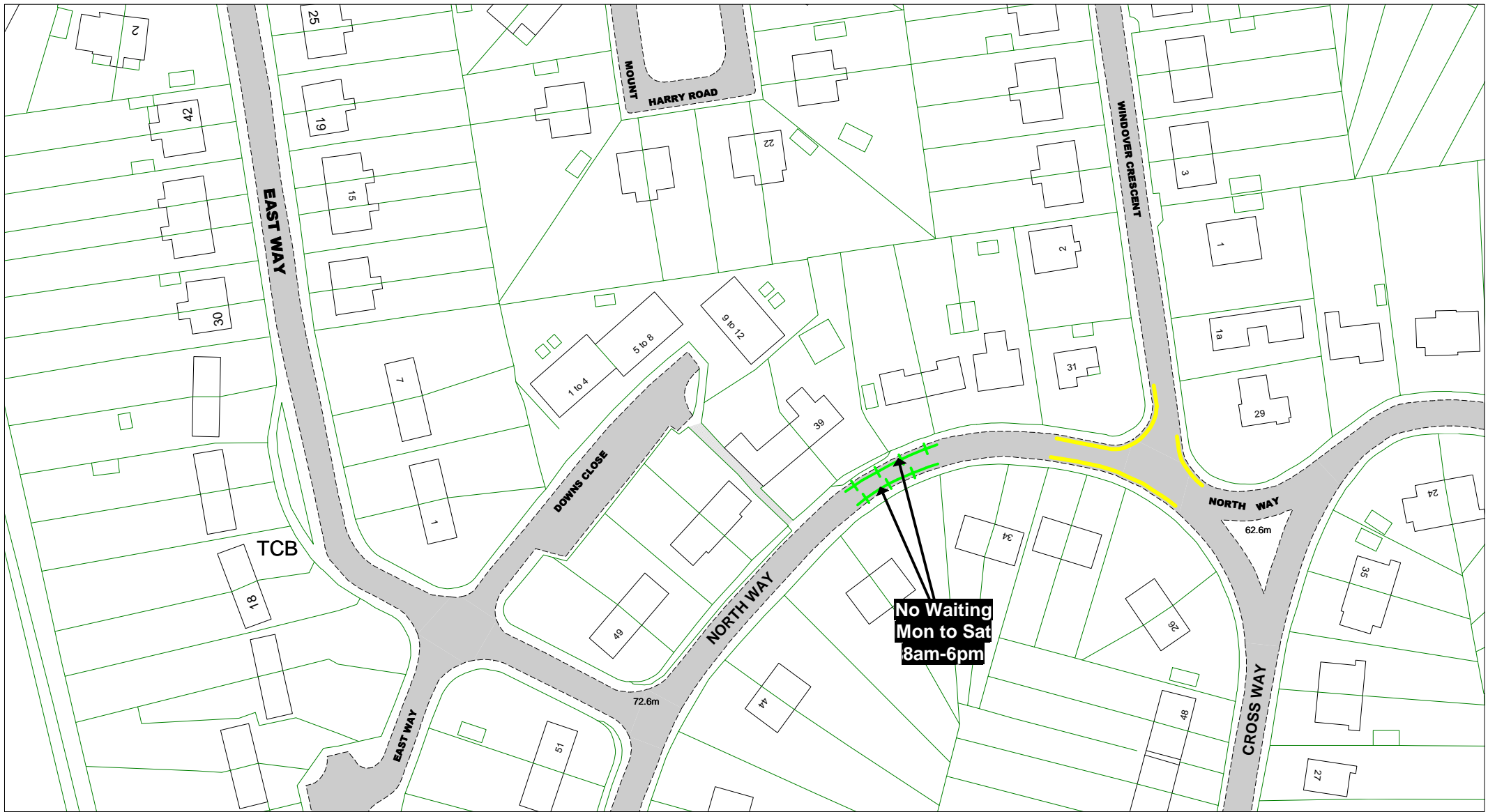

**The East Sussex Lewes Town
(Parking Places and Waiting
and Loading Restrictions)
Traffic Regulation Order 2014
Amendment No.1 2016**

Key to TRO Restriction Types

- No Waiting at Any Time
- No Waiting
- No Loading at Any Time
- No Loading
- Pay and Display
- Permit Holders Only
- Permit Holder or Pay and Display
- Limited Waiting
- Disabled Badge Holders Only
- Car Club Permit Only
- Loading/ Unloading Only
- Motorcycles Only
- Taxi Only
- No Stopping
On Entrance Markings
- Restricted Parking Zone
No Waiting at Any Time

© Crown copyright. All rights reserved
East Sussex County Council
Licence No. 100019601 2016

Adjacent Map Tile

LJ102

LJ103



SCALE	1 : 1000
DATE	23/09/2016
Tile Ref: LJ102	Revision: 0

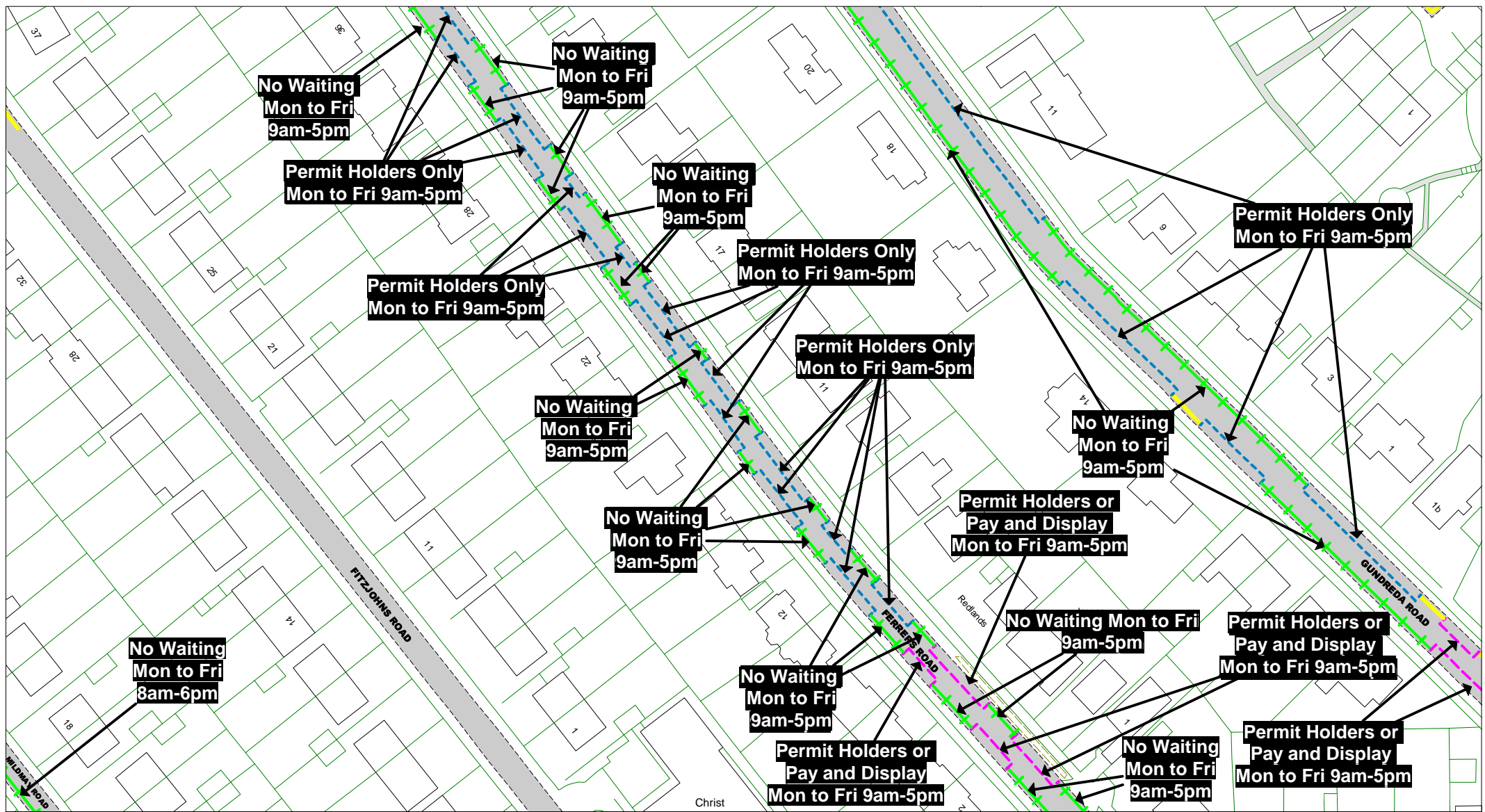

The East Sussex Lewes Town
(Parking Places and Waiting
and Loading Restrictions)
Traffic Regulation Order 2014
Amendment No.1 2016

Key to TRO Restriction Types

- No Waiting at Any Time
- No Waiting
- No Loading at Any Time
- No Loading
- Pay and Display
- Permit Holders Only
- Permit Holder or Pay and Display
- Limited Waiting
- Disabled Badge Holders Only
- Car Club Permit Only

- Loading/ Unloading Only
- Motorcycles Only
- Taxi Only
- No Stopping On Entrance Markings
- Restricted Parking Zone No Waiting at Any Time

© Crown copyright. All rights reserved
East Sussex County Council
Licence No. 100019601 2016

Adjacent Map Tile

- LJ104
- LK103
- LK105
- LL104



SCALE	1 : 1000
DATE	23/09/2016
Tile Ref: LK104	Revision: 1

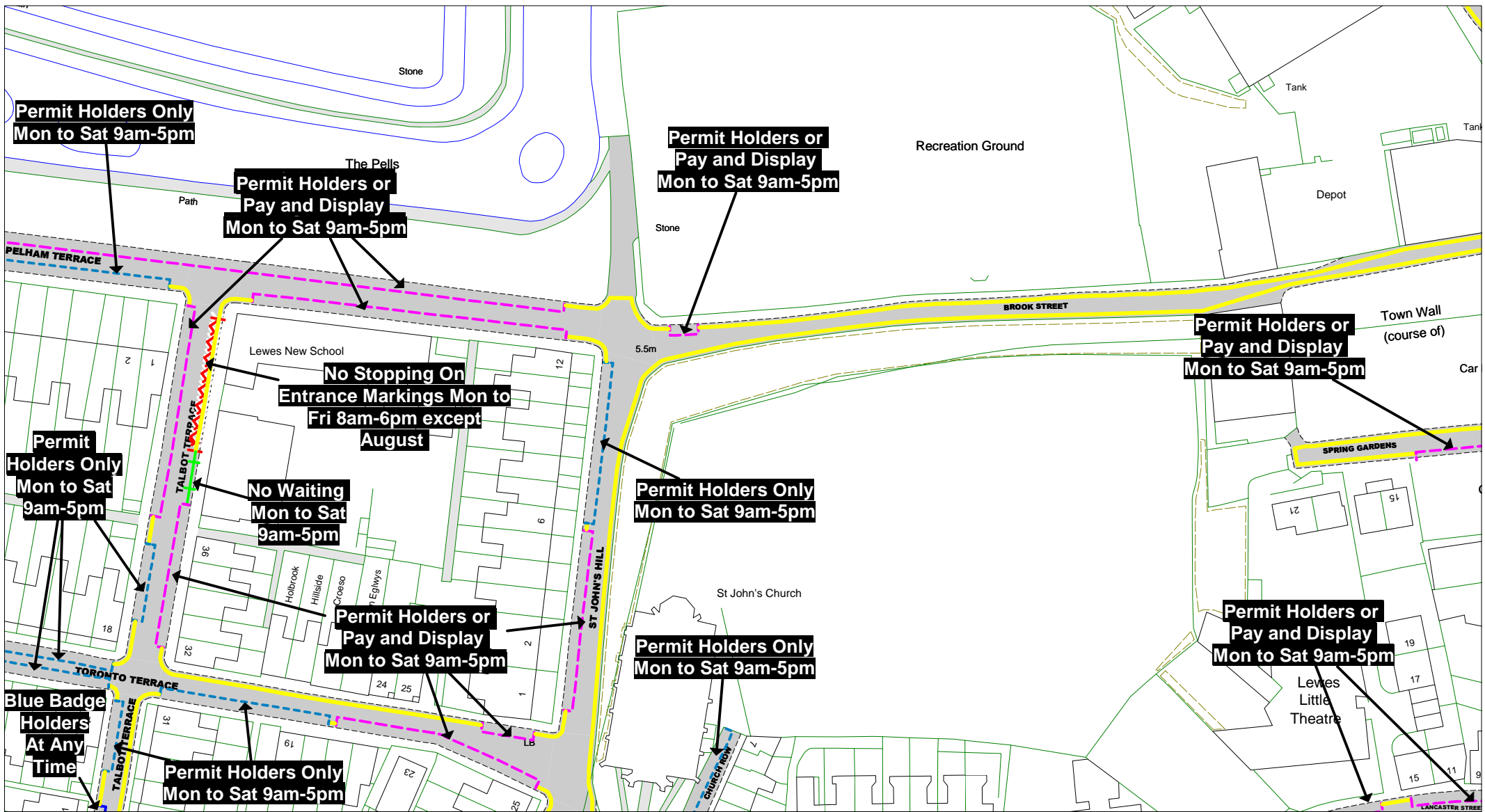

The East Sussex Lewes Town
(Parking Places and Waiting
and Loading Restrictions)
Traffic Regulation Order 2014
Amendment No.1 2016

Key to TRO Restriction Types

- No Waiting at Any Time
- No Waiting
- No Loading at Any Time
- No Loading
- Pay and Display
- Permit Holders Only
- - - Permit Holder or Pay and Display
- Limited Waiting
- Disabled Badge Holders Only
- Car Club Permit Only
- Loading/ Unloading Only
- Motorcycles Only
- Taxi Only
- No Stopping On Entrance Markings
- Restricted Parking Zone
- No Waiting at Any Time

© Crown copyright. All rights reserved
East Sussex County Council
Licence No. 100019601 2016

Adjacent Map Tile

- ▲ LJ107
- ← LK106
- ▶ LK108
- ▼ LL107



SCALE	1 : 1000
DATE	23/09/2016
Tile Ref: LK107	Revision: 1

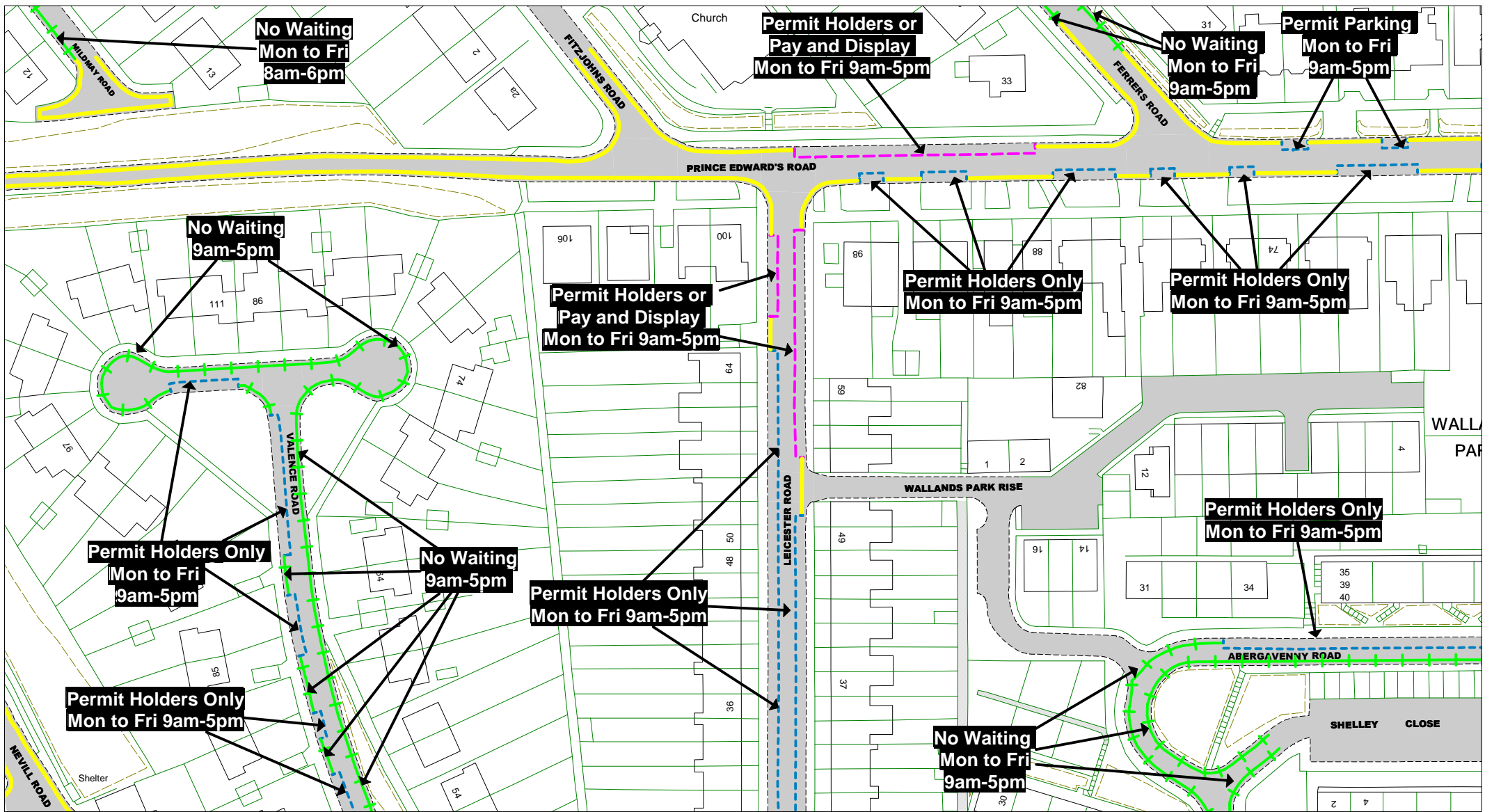

The East Sussex Lewes Town
(Parking Places and Waiting
and Loading Restrictions)
Traffic Regulation Order 2014
Amendment No.1 2016

Key to TRO Restriction Types

- No Waiting at Any Time
- No Waiting
- No Loading at Any Time
- No Loading
- Pay and Display
- Permit Holders Only
- - Permit Holder or Pay and Display
- Limited Waiting
- Disabled Badge Holders Only
- - Car Club Permit Only
- Loading/ Unloading Only
- Motorcycles Only
- Taxi Only
- No Stopping On Entrance Markings
- Restricted Parking Zone
- No Waiting at Any Time

© Crown copyright. All rights reserved
East Sussex County Council
Licence No. 100019601 2016

Adjacent Map Tile

- ▲ **LK104**
- ◀ **LL103**
- LL105** ▶
- ▼ **LM104**



SCALE	1 : 1000
DATE	23/09/2016
Tile Ref: LL104	Revision: 1

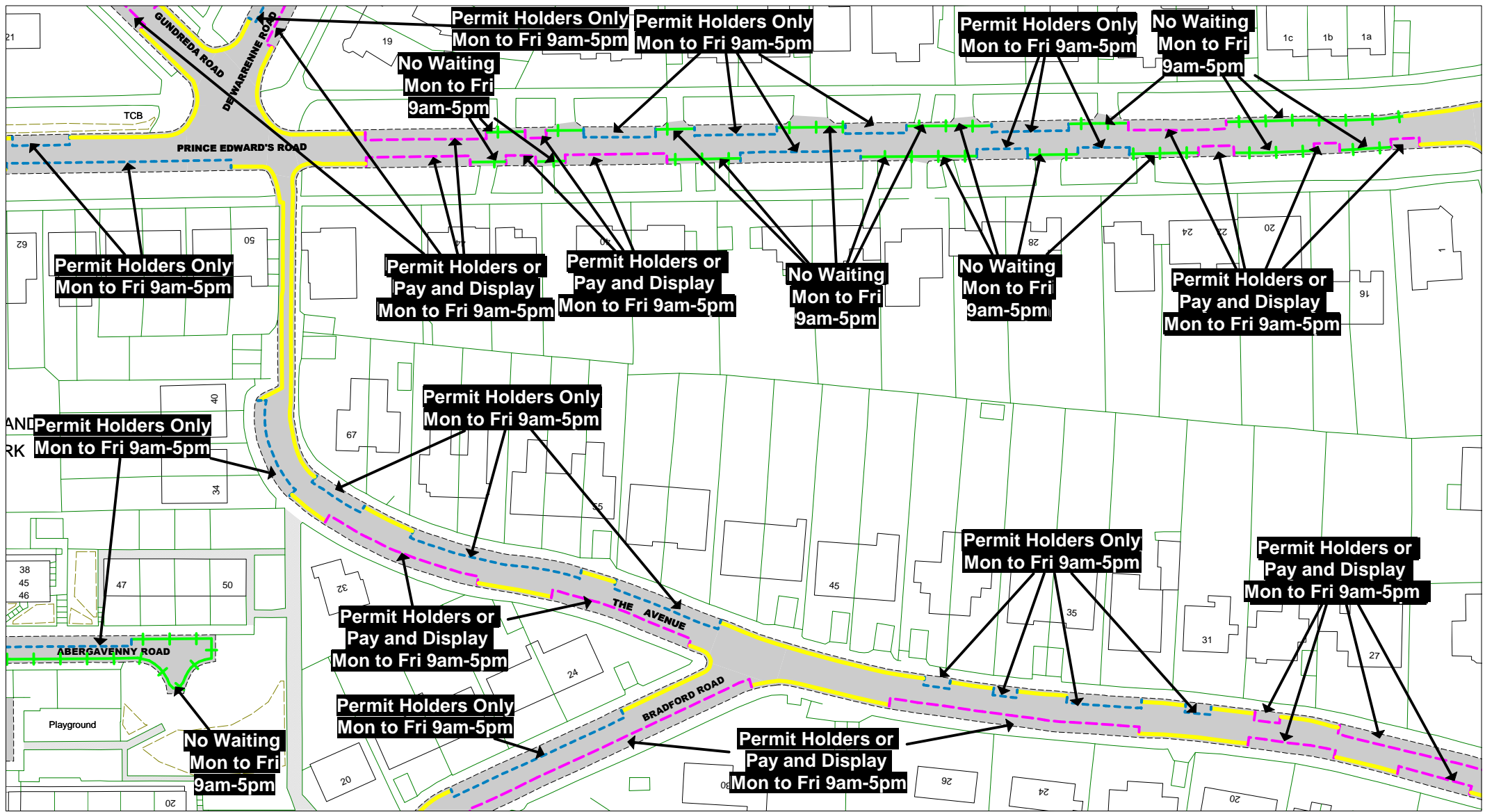

The East Sussex Lewes Town
(Parking Places and Waiting
and Loading Restrictions)
Traffic Regulation Order 2014
Amendment No.1 2016

Key to TRO Restriction Types

- No Waiting at Any Time
- + + No Waiting
- + + No Loading at Any Time
- + + No Loading
- + + Pay and Display
- - Permit Holders Only
- - Permit Holder or Pay and Display
- - Limited Waiting
- - Disabled Badge Holders Only
- - Car Club Permit Only
- - Loading/ Unloading Only
- - Motorcycles Only
- - Taxi Only
- ~ ~ No Stopping On Entrance Markings
- X X Restricted Parking Zone
- - No Waiting at Any Time

© Crown copyright. All rights reserved
East Sussex County Council
Licence No. 100019601 2016

Adjacent Map Tile

- ↑ **LK105**
- ← **LL104**
- **LL106**
- ↓ **LM105**



SCALE	1 : 1000
DATE	23/09/2016
Tile Ref: LL105	Revision: 1

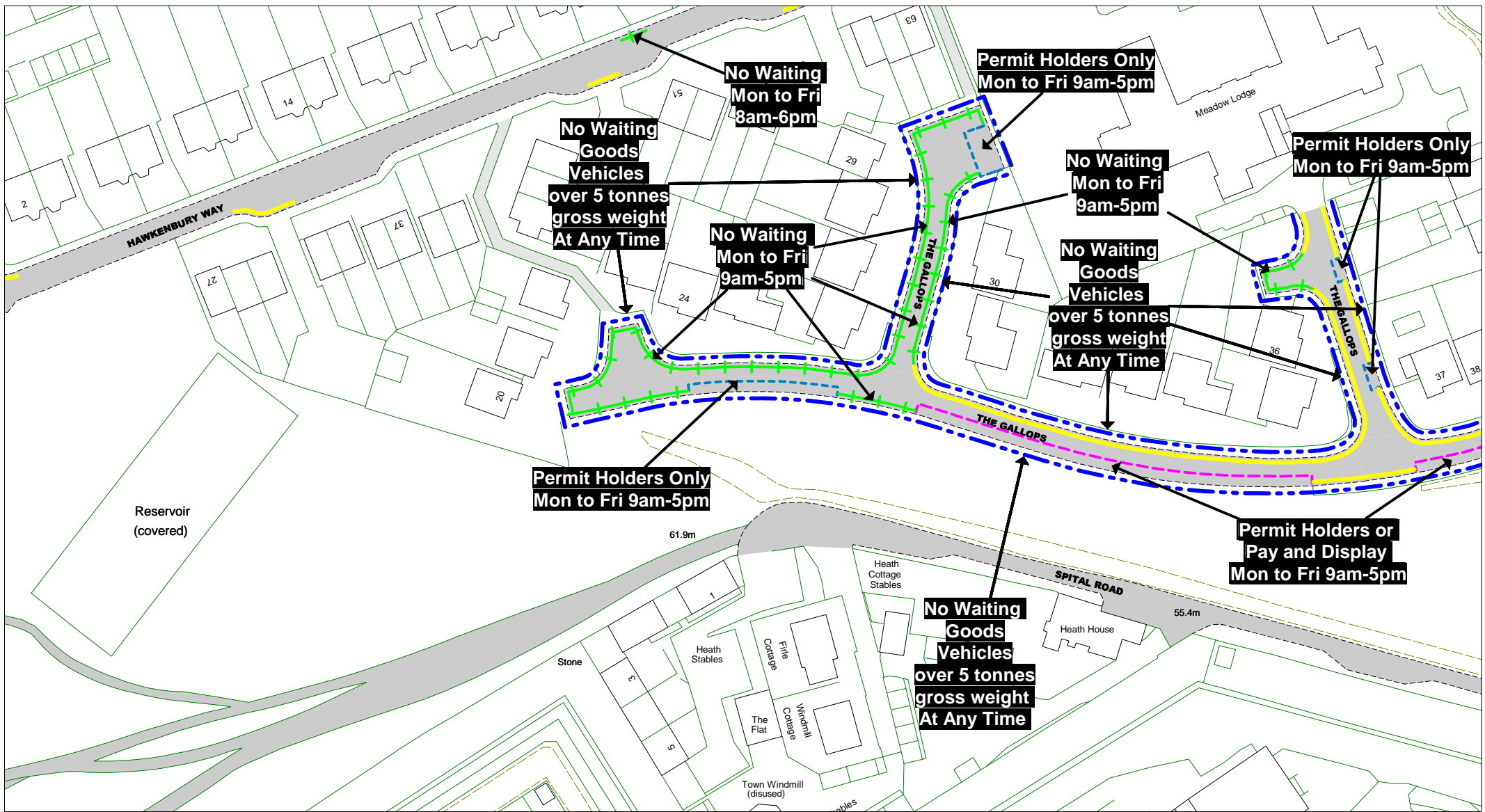

The East Sussex Lewes Town
(Parking Places and Waiting
and Loading Restrictions)
Traffic Regulation Order 2014
Amendment No.1 2016

Key to TRO Restriction Types

- No Waiting at Any Time
- No Waiting
- No Loading at Any Time
- No Loading
- Pay and Display
- Permit Holders Only
- Permit Holder or Pay and Display
- Limited Waiting
- Disabled Badge Holders Only
- Car Club Permit Only
- Loading/ Unloading Only
- Motorcycles Only
- Taxi Only
- No Stopping On Entrance Markings
- Restricted Parking Zone No Waiting at Any Time

© Crown copyright. All rights reserved
East Sussex County Council
Licence No. 100019601 2016

Adjacent Map Tile

- LL103
- LM102
- LM104
- LN103



SCALE	1 : 1000
DATE	23/09/2016
Tile Ref: LM103	Revision: 1

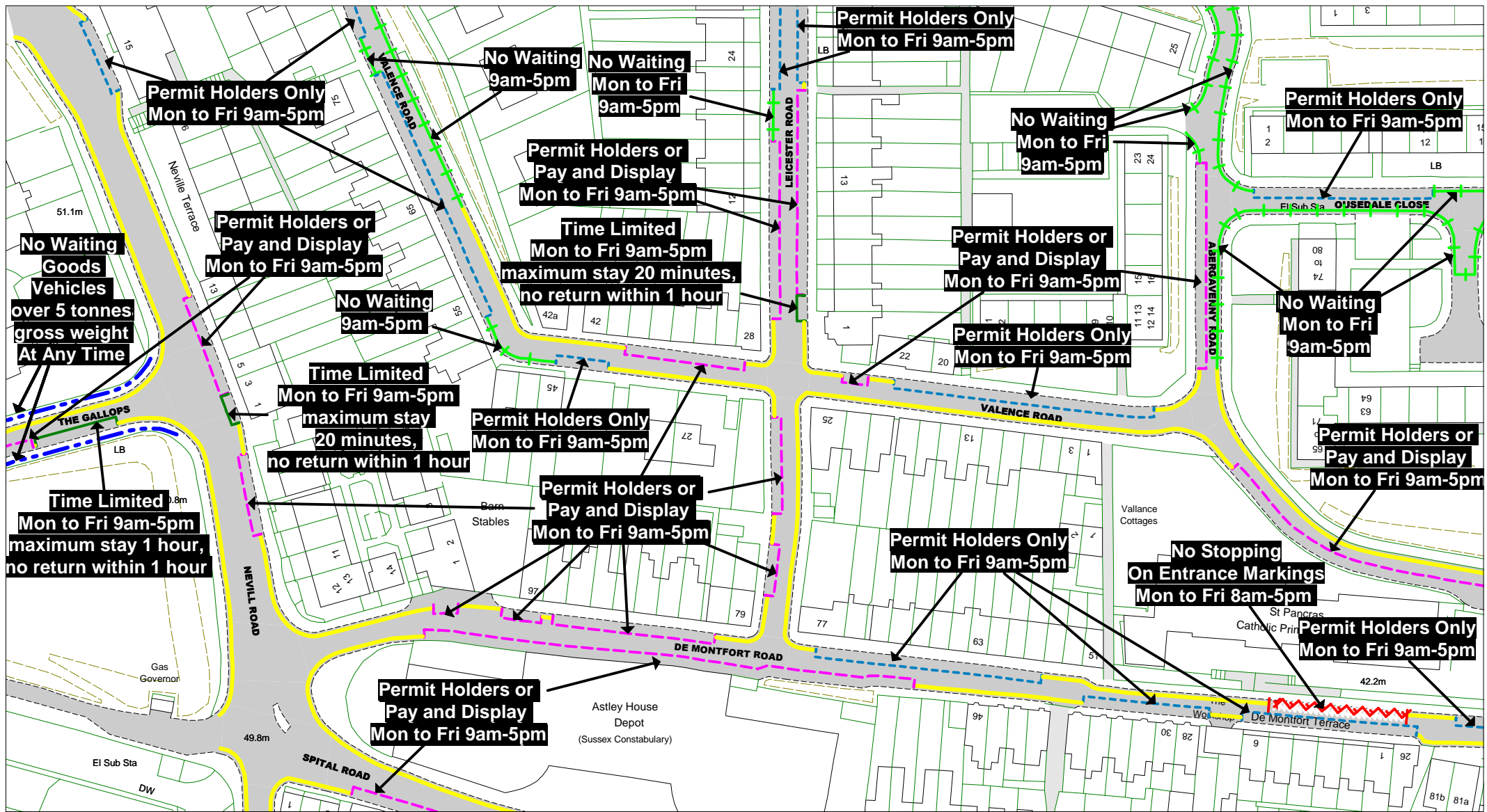

The East Sussex Lewes Town
(Parking Places and Waiting
and Loading Restrictions)
Traffic Regulation Order 2014
Amendment No.1 2016

Key to TRO Restriction Types

- No Waiting at Any Time
- No Waiting
- No Loading at Any Time
- No Loading
- Pay and Display
- Permit Holders Only
- Permit Holder or Pay and Display
- Limited Waiting
- Disabled Badge Holders Only
- Car Club Permit Only

- Loading/ Unloading Only
- Motorcycles Only
- Taxi Only
- No Stopping On Entrance Markings
- Restricted Parking Zone No Waiting at Any Time

© Crown copyright. All rights reserved
East Sussex County Council
Licence No. 100019601 2016

Adjacent Map Tile

- LL104
- LM103
- LM105
- LN104



SCALE	1 : 1000
DATE	23/09/2016
Tile Ref: LM104	Revision: 1

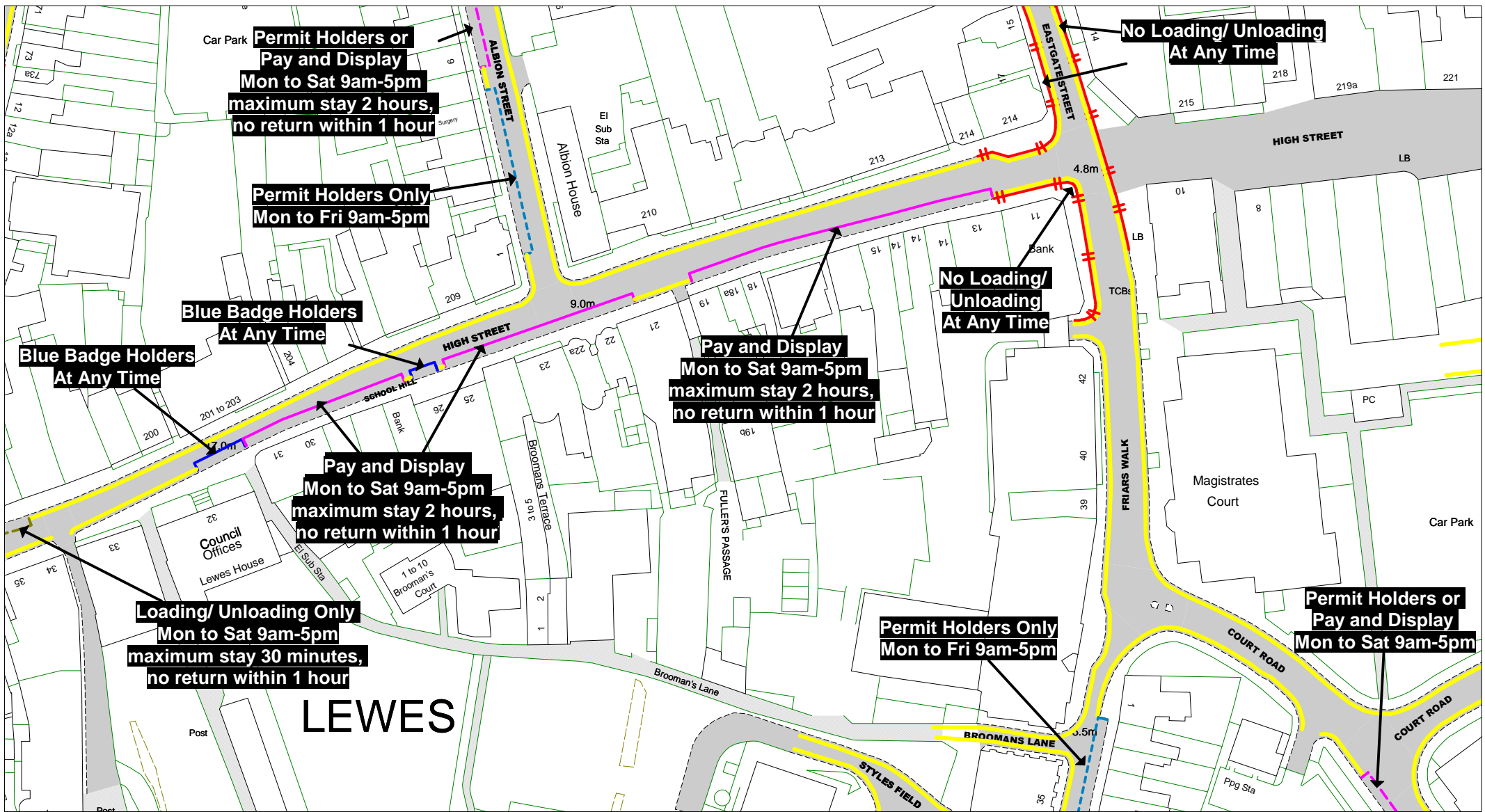

LEWES



The East Sussex Lewes Town
(Parking Places and Waiting
and Loading Restrictions)
Traffic Regulation Order 2014
Amendment No.1 2016

Key to TRO Restriction Types

- No Waiting at Any Time
- + No Waiting
- + No Loading at Any Time
- + No Loading
- Pay and Display
- Permit Holders Only
- Permit Holder or Pay and Display
- Limited Waiting
- Disabled Badge Holders Only
- Car Club Permit Only
- Loading/ Unloading Only
- Motorcycles Only
- Taxi Only
- ~ No Stopping On Entrance Markings
- X Restricted Parking Zone No Waiting at Any Time

© Crown copyright. All rights reserved
East Sussex County Council
Licence No. 100019601 2016

Adjacent Map Tile

- LL108
- LM107
- LM109
- LN108



SCALE	1 : 1000
DATE	23/09/2016
Tile Ref: LM108	Revision: 1

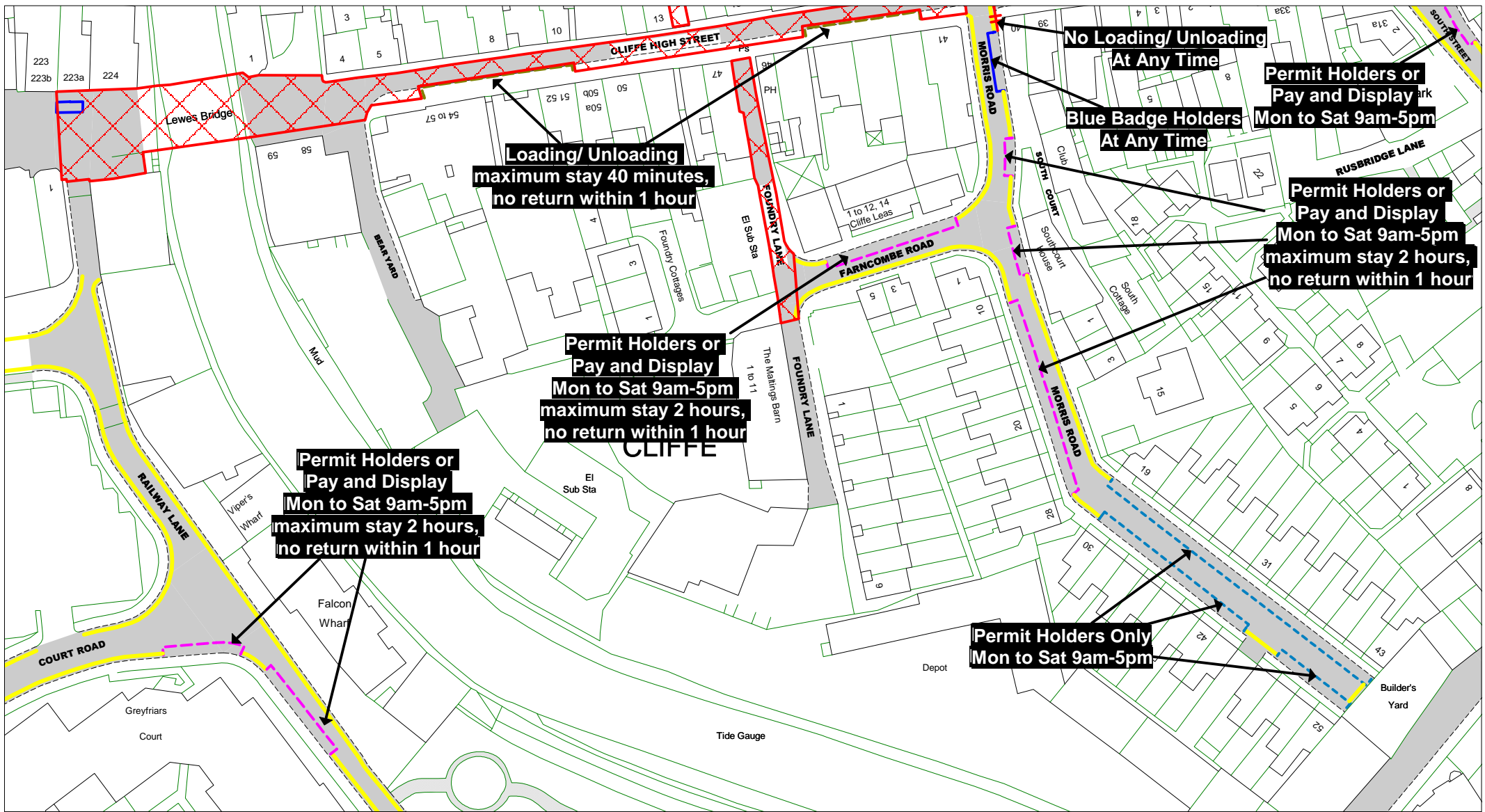

The East Sussex Lewes Town
(Parking Places and Waiting
and Loading Restrictions)
Traffic Regulation Order 2014
Amendment No.1 2016

- Key to TRO Restriction Types**
- No Waiting at Any Time
 - No Waiting
 - No Loading at Any Time
 - No Loading
 - Pay and Display
 - Permit Holders Only
 - Permit Holder or Pay and Display
 - Limited Waiting
 - Disabled Badge Holders Only
 - Car Club Permit Only

- Loading/Unloading Only
 - Motorcycles Only
 - Taxi Only
 - No Stopping On Entrance Markings
 - Restricted Parking Zone No Waiting at Any Time
- © Crown copyright. All rights reserved
East Sussex County Council
Licence No. 100019601 2016

Adjacent Map Tile

LL109
LM108
LM110
LN109



SCALE	1 : 1000
DATE	23/09/2016
Tile Ref: LM109	Revision: 1

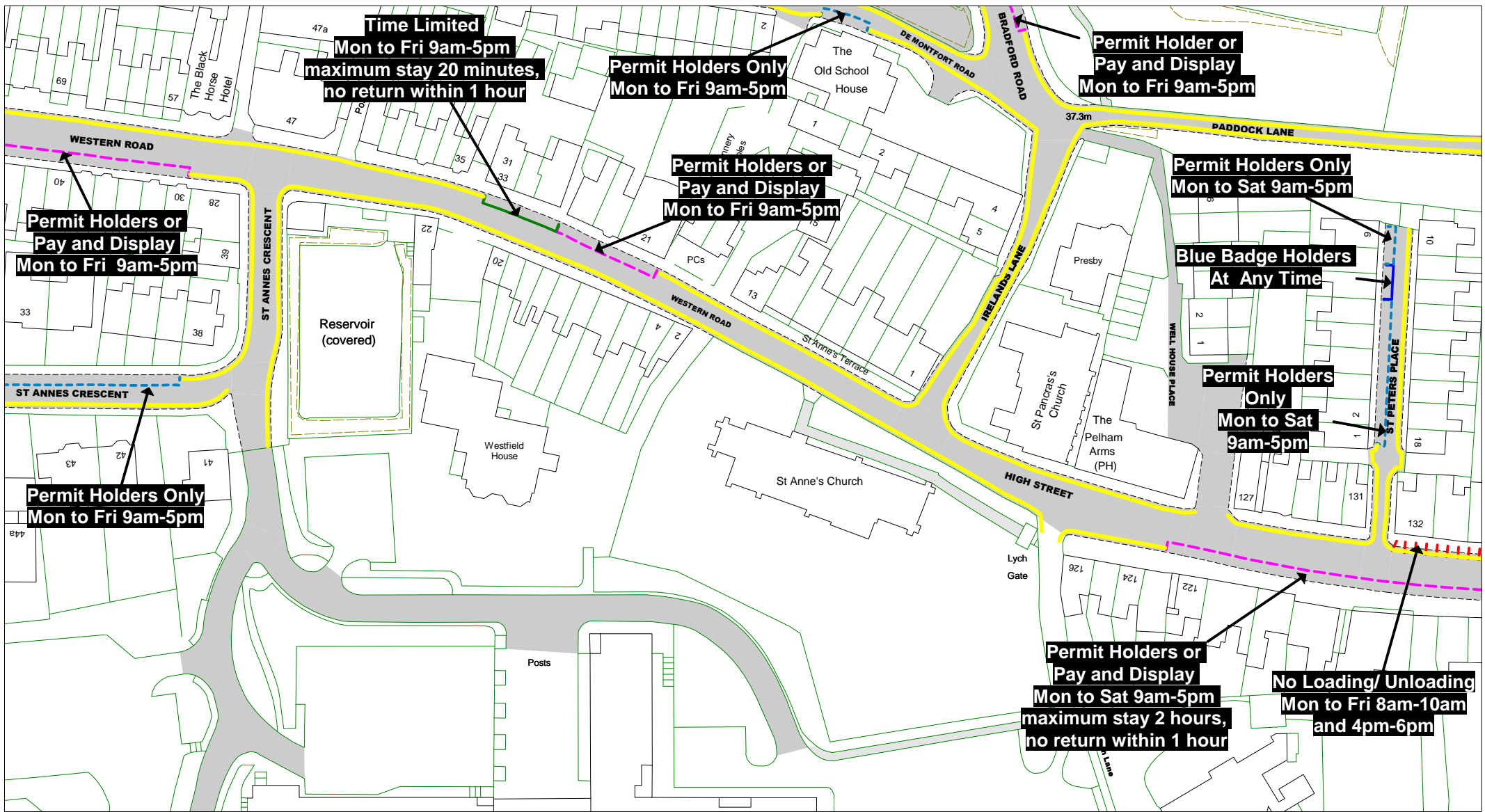

The East Sussex Lewes Town
(Parking Places and Waiting
and Loading Restrictions)
Traffic Regulation Order 2014
Amendment No.1 2016

- Key to TRO Restriction Types**
- No Waiting at Any Time
 - No Waiting
 - No Loading at Any Time
 - No Loading
 - Pay and Display
 - Permit Holders Only
 - Permit Holder or Pay and Display
 - Limited Waiting
 - Disabled Badge Holders Only
 - Car Club Permit Only

- Loading/ Unloading Only
 - Motorcycles Only
 - Taxi Only
 - No Stopping On Entrance Markings
 - Restricted Parking Zone No Waiting at Any Time
- © Crown copyright. All rights reserved
East Sussex County Council
Licence No. 100019601 2016

Adjacent Map Tile

LM105
LN104
LN106
LO105

SCALE	1 : 1000
DATE	23/09/2016
Tile Ref: LN105	Revision: 1

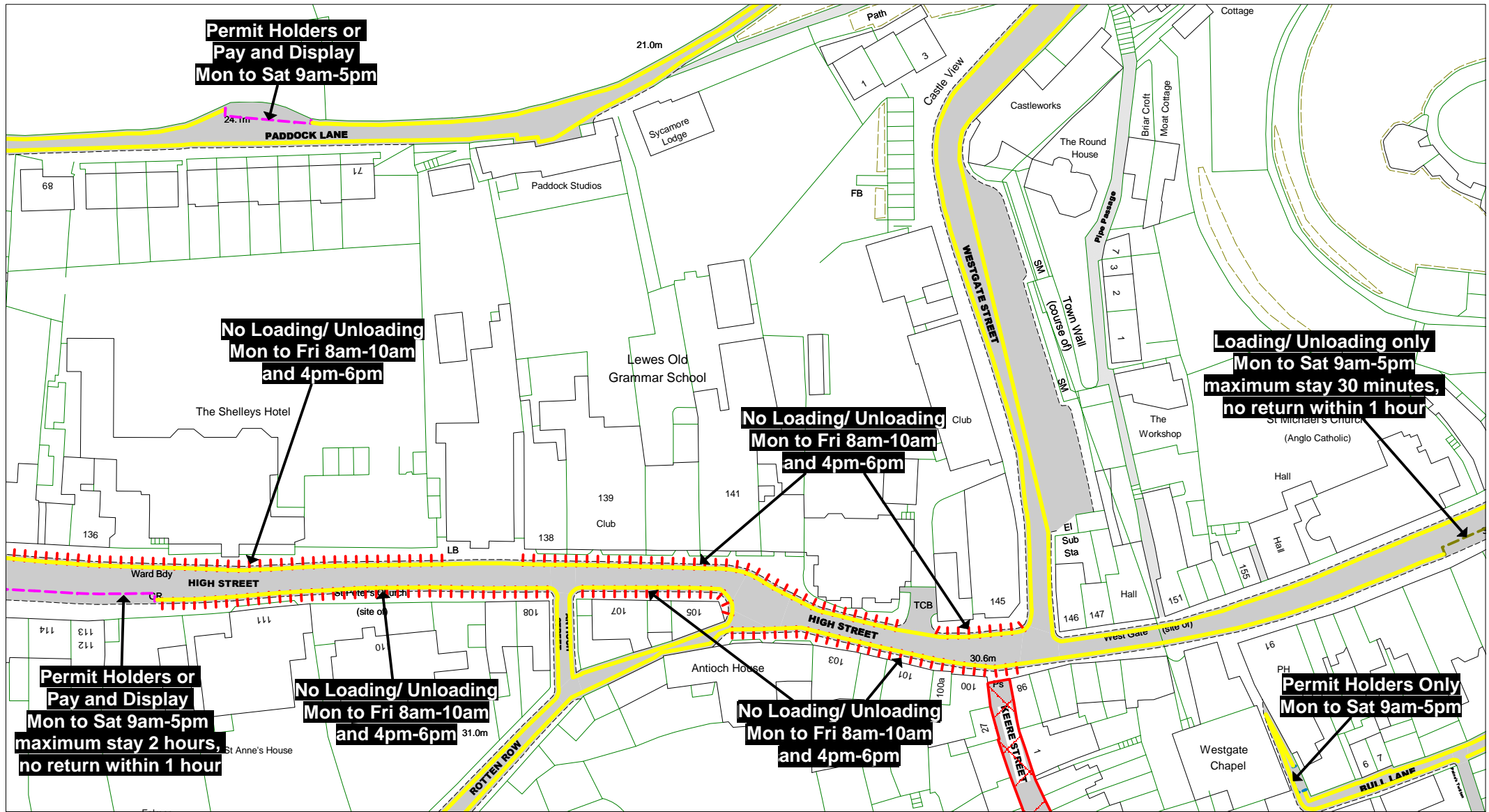

The East Sussex Lewes Town
(Parking Places and Waiting
and Loading Restrictions)
Traffic Regulation Order 2014
Amendment No.1 2016

Key to TRO Restriction Types

- No Waiting at Any Time
- No Waiting
- No Loading at Any Time
- No Loading
- Pay and Display
- Permit Holders Only
- Permit Holder or Pay and Display
- Limited Waiting
- Disabled Badge Holders Only
- Car Club Permit Only

- Loading/ Unloading Only
- Motorcycles Only
- Taxi Only
- No Stopping On Entrance Markings
- Restricted Parking Zone No Waiting at Any Time

© Crown copyright. All rights reserved
East Sussex County Council
Licence No. 100019601 2016

Adjacent Map Tile

- LM106**
- LN105**
- LN107**
- LO106**



SCALE	1 : 1000
DATE	23/09/2016
Tile Ref: LN106	Revision: 1

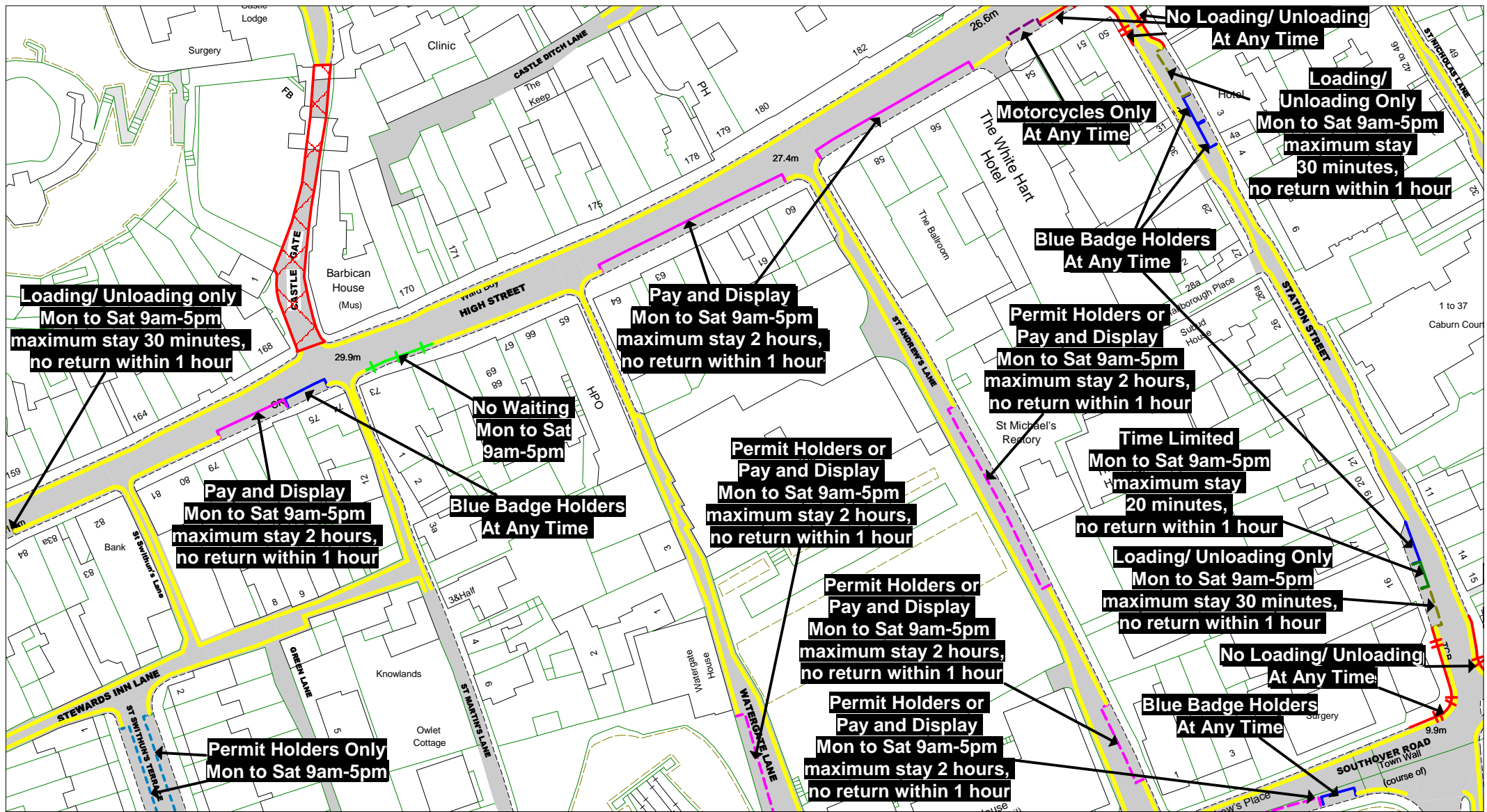

The East Sussex Lewes Town
(Parking Places and Waiting
and Loading Restrictions)
Traffic Regulation Order 2014
Amendment No.1 2016

Key to TRO Restriction Types

- No Waiting at Any Time
- No Waiting
- No Loading at Any Time
- No Loading
- Pay and Display
- Permit Holders Only
- Permit Holder or Pay and Display
- Limited Waiting
- Disabled Badge Holders Only
- Car Club Permit Only
- Loading/ Unloading Only
- Motorcycles Only
- Taxi Only
- No Stopping On Entrance Markings
- Restricted Parking Zone
- No Waiting at Any Time

© Crown copyright. All rights reserved
East Sussex County Council
Licence No. 100019601 2016

Adjacent Map Tile

- LM107
- LN106
- LN108
- LO107



SCALE	1 : 1000
DATE	23/09/2016
Tile Ref: LN107	Revision: 1

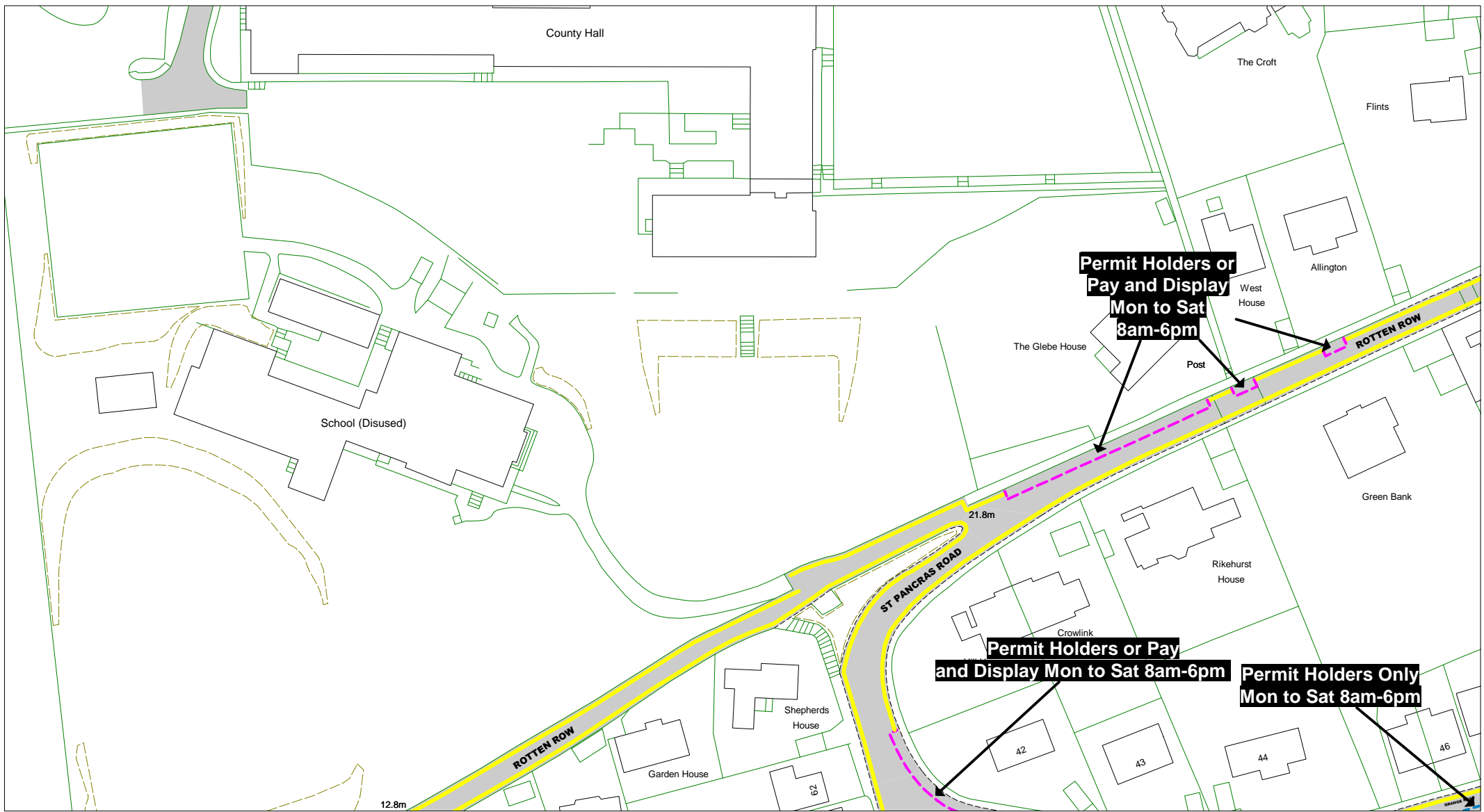

**The East Sussex Lewes Town
(Parking Places and Waiting
and Loading Restrictions)
Traffic Regulation Order 2014
Amendment No.1 2016**

Key to TRO Restriction Types

- No Waiting at Any Time
- No Waiting
- No Loading at Any Time
- No Loading
- Pay and Display
- Permit Holders Only
- Permit Holder or Pay and Display
- Limited Waiting
- Disabled Badge Holders Only
- Car Club Permit Only
- Loading/ Unloading Only
- Motorcycles Only
- Taxi Only
- No Stopping On Entrance Markings
- Restricted Parking Zone No Waiting at Any Time

© Crown copyright. All rights reserved
East Sussex County Council
Licence No. 100019601 2016

Adjacent Map Tile

- LN105
- LO104
- LO106
- LP105



SCALE	1 : 1000
DATE	23/09/2016
Tile Ref: LO105	Revision: 1

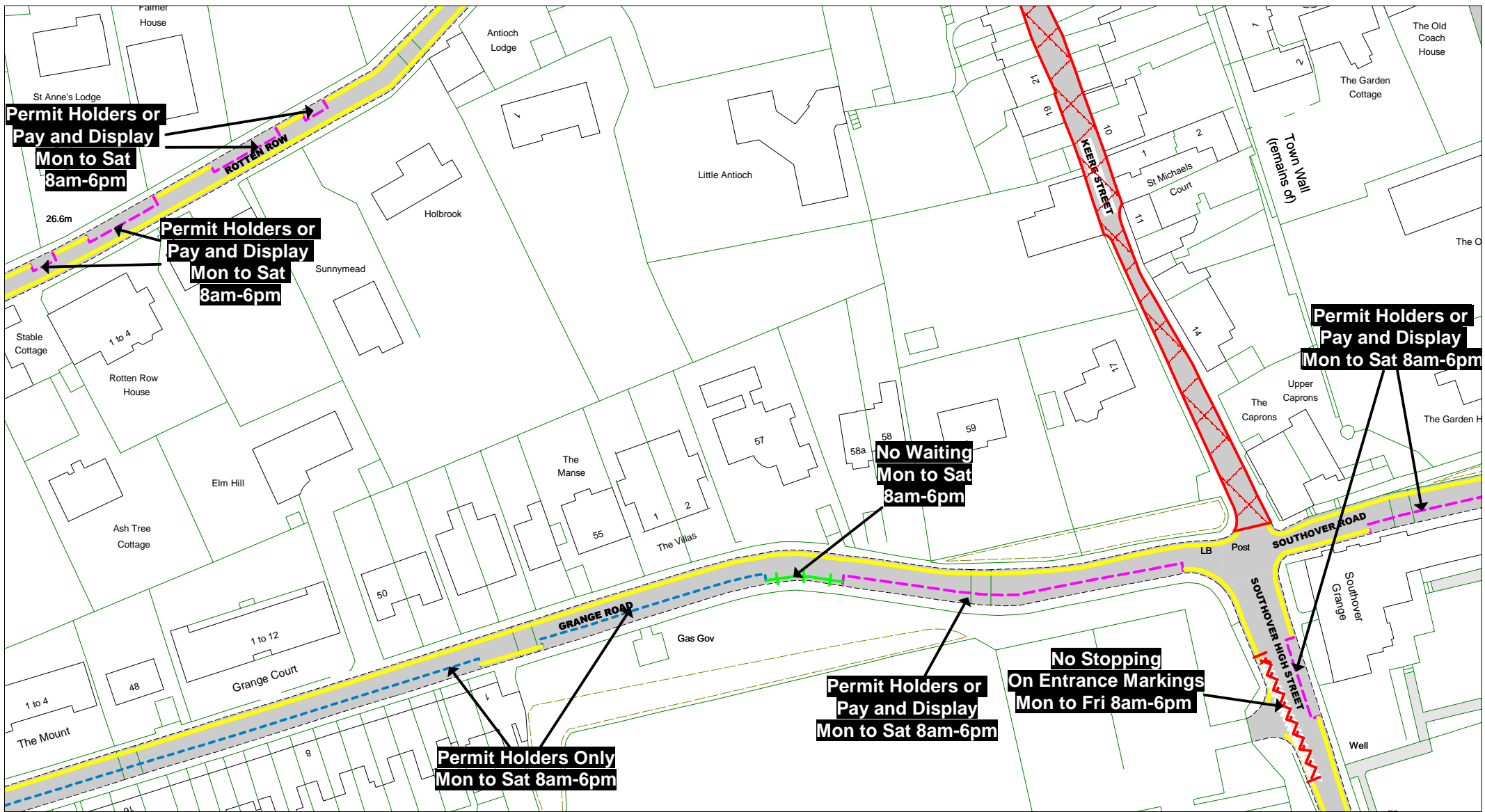

The East Sussex Lewes Town
(Parking Places and Waiting
and Loading Restrictions)
Traffic Regulation Order 2014
Amendment No.1 2016

Key to TRO Restriction Types

- No Waiting at Any Time
- No Waiting
- No Loading at Any Time
- No Loading
- Pay and Display
- Permit Holders Only
- Permit Holder or Pay and Display
- Limited Waiting
- Disabled Badge Holders Only
- Car Club Permit Only
- Loading/ Unloading Only
- Motorcycles Only
- Taxi Only
- No Stopping On Entrance Markings
- Restricted Parking Zone No Waiting at Any Time

© Crown copyright. All rights reserved
East Sussex County Council
Licence No. 100019601 2016

Adjacent Map Tile

- LN106**
- LO105**
- LO107**
- LP106**



SCALE	1 : 1000
DATE	23/09/2016
Tile Ref: LO106	Revision: 1

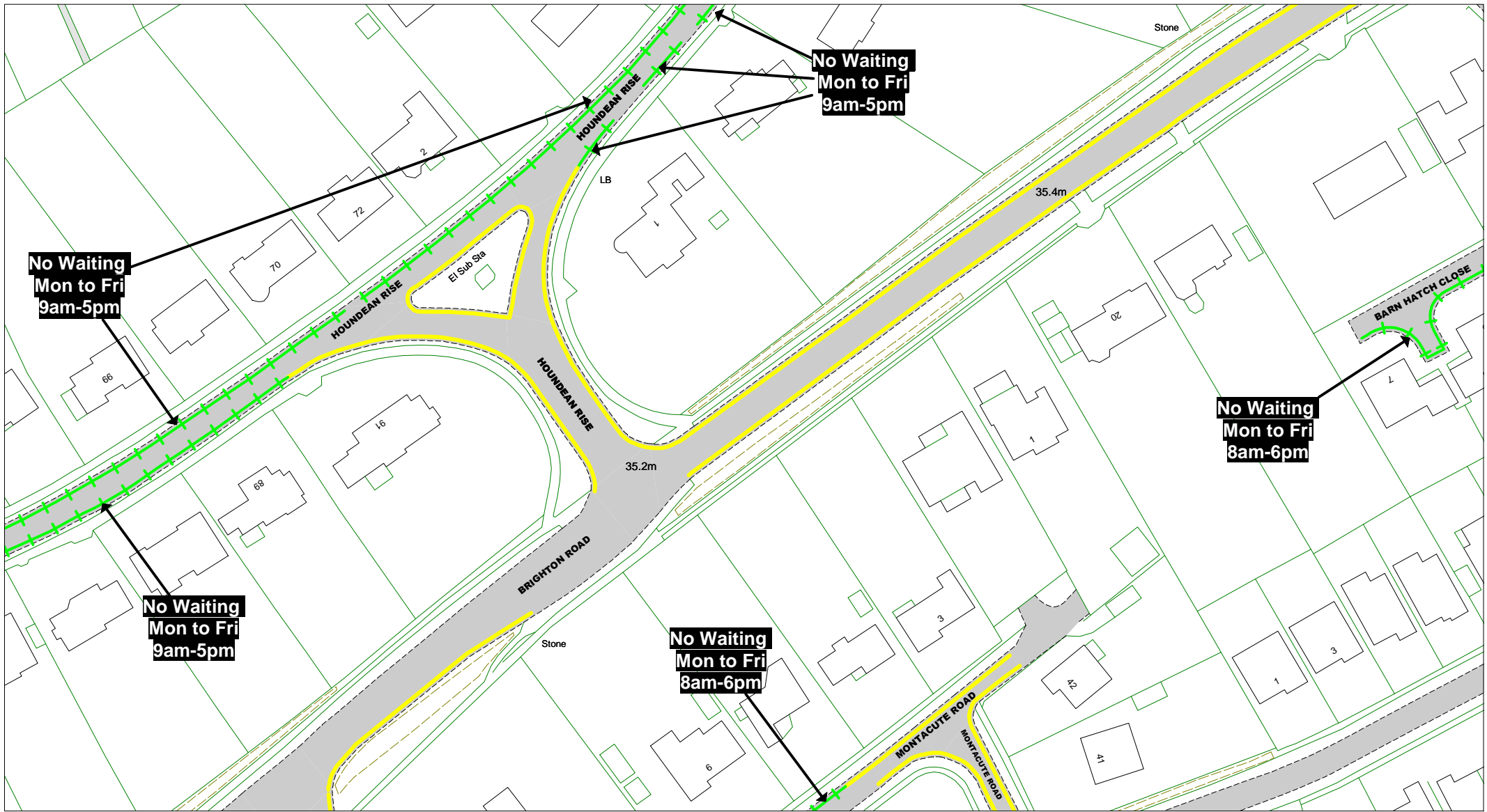

The East Sussex Lewes Town
(Parking Places and Waiting
and Loading Restrictions)
Traffic Regulation Order 2014
Amendment No.1 2016

Key to TRO Restriction Types

- No Waiting at Any Time
- No Waiting
- No Loading at Any Time
- No Loading
- Pay and Display
- Permit Holders Only
- Permit Holder or Pay and Display
- Limited Waiting
- Disabled Badge Holders Only
- Car Club Permit Only
- Loading/ Unloading Only
- Motorcycles Only
- Taxi Only
- No Stopping On Entrance Markings
- Restricted Parking Zone No Waiting at Any Time

© Crown copyright. All rights reserved
East Sussex County Council
Licence No. 100019601 2016

Adjacent Map Tile

- LO102**
- LP101**
- LP103**
- LQ102**



SCALE	1 : 1000
DATE	23/09/2016
Tile Ref: LP102	Revision: 1

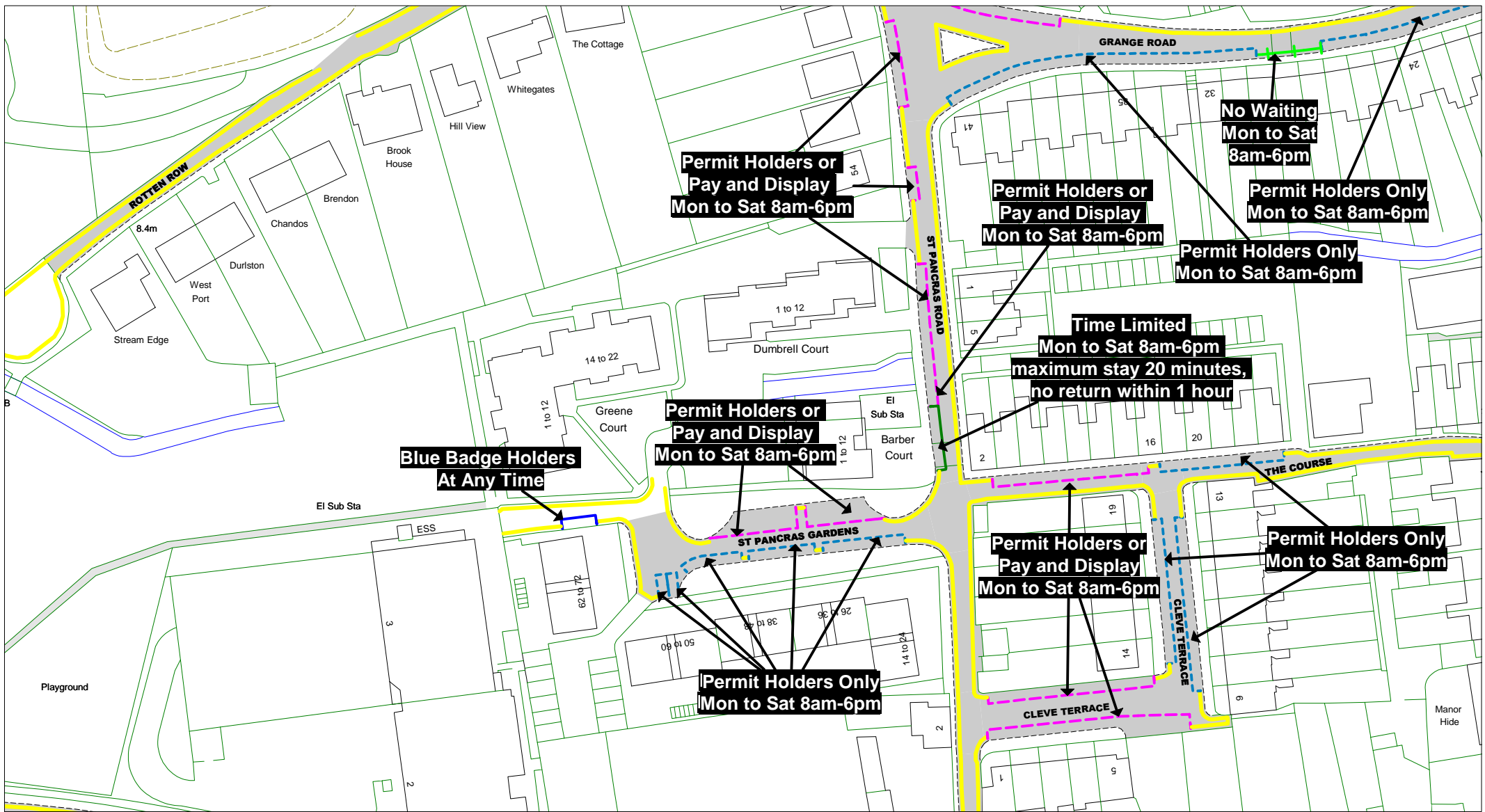

The East Sussex Lewes Town
(Parking Places and Waiting
and Loading Restrictions)
Traffic Regulation Order 2014
Amendment No.1 2016

Key to TRO Restriction Types

- No Waiting at Any Time
- No Waiting
- No Loading at Any Time
- No Loading
- Pay and Display
- Permit Holders Only
- Permit Holder or Pay and Display
- Limited Waiting
- Disabled Badge Holders Only
- Car Club Permit Only
- Loading/ Unloading Only
- Motorcycles Only
- Taxi Only
- No Stopping On Entrance Markings
- Restricted Parking Zone No Waiting at Any Time

© Crown copyright. All rights reserved
East Sussex County Council
Licence No. 100019601 2016

Adjacent Map Tile

- LO105
- LP104
- LP106
- LQ105



SCALE	1 : 1000
DATE	23/09/2016
Tile Ref: LP105	Revision: 1

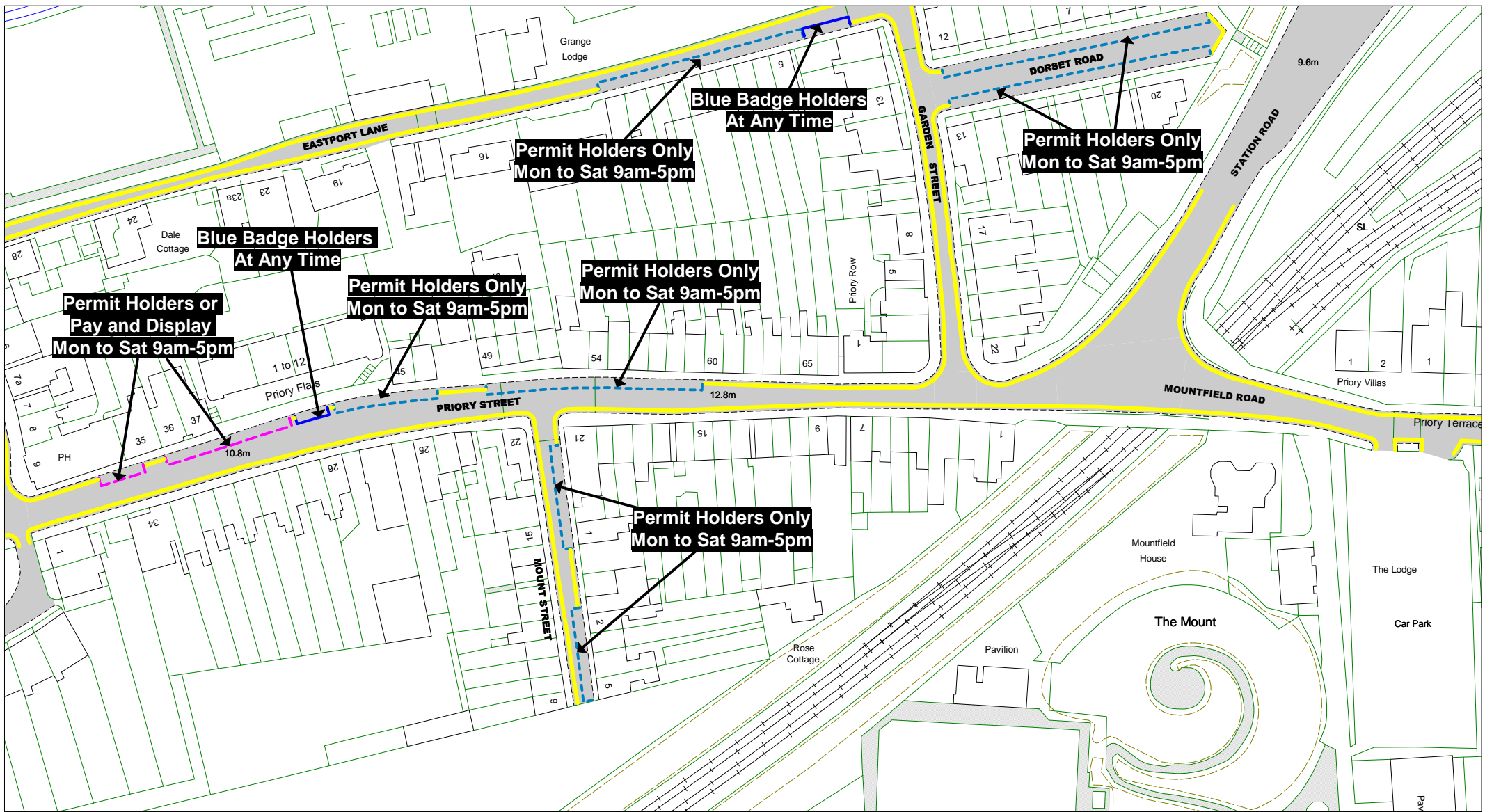

The East Sussex Lewes Town
(Parking Places and Waiting
and Loading Restrictions)
Traffic Regulation Order 2014
Amendment No.1 2016

Key to TRO Restriction Types

- No Waiting at Any Time
- No Waiting
- No Loading at Any Time
- No Loading
- Pay and Display
- Permit Holders Only
- Permit Holder or Pay and Display
- Limited Waiting
- Disabled Badge Holders Only
- Car Club Permit Only
- Loading/ Unloading Only
- Motorcycles Only
- Taxi Only
- No Stopping On Entrance Markings
- Restricted Parking Zone No Waiting at Any Time

© Crown copyright. All rights reserved
East Sussex County Council
Licence No. 100019601 2016

Adjacent Map Tile

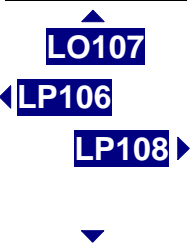

SCALE	1 : 1000
DATE	23/09/2016
Tile Ref: LP107	Revision: 1

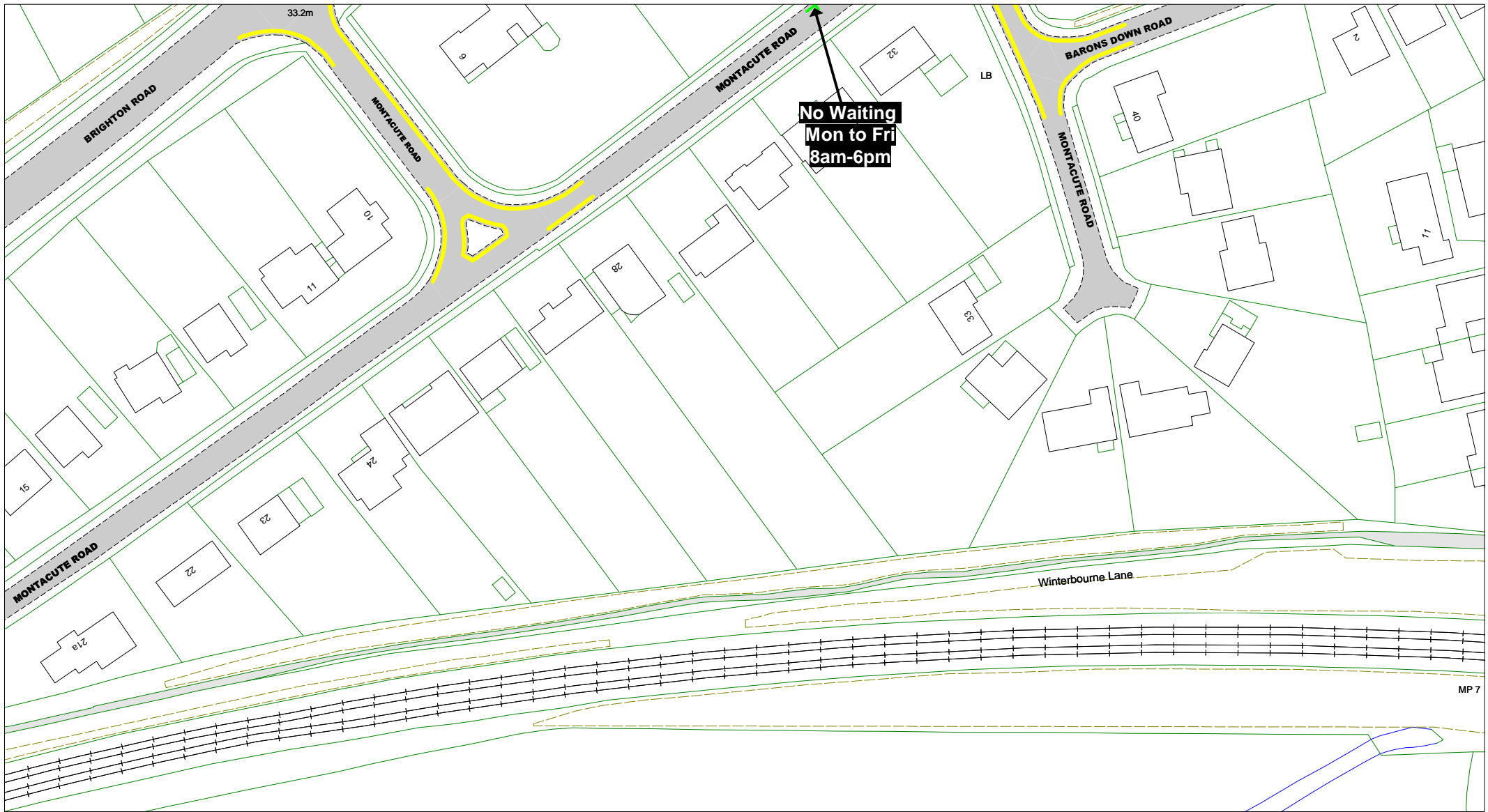

The East Sussex Lewes Town
(Parking Places and Waiting
and Loading Restrictions)
Traffic Regulation Order 2014
Amendment No.1 2016

Key to TRO Restriction Types

- No Waiting at Any Time
- No Waiting
- No Loading at Any Time
- No Loading
- Pay and Display
- Permit Holders Only
- Permit Holder or Pay and Display
- Limited Waiting
- Disabled Badge Holders Only
- Car Club Permit Only
- Loading/ Unloading Only
- Motorcycles Only
- Taxi Only
- No Stopping On Entrance Markings
- Restricted Parking Zone No Waiting at Any Time

© Crown copyright. All rights reserved
East Sussex County Council
Licence No. 100019601 2016

Adjacent Map Tile

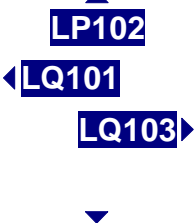

SCALE	1 : 1000
DATE	23/09/2016
Tile Ref: LQ102	Revision: 1

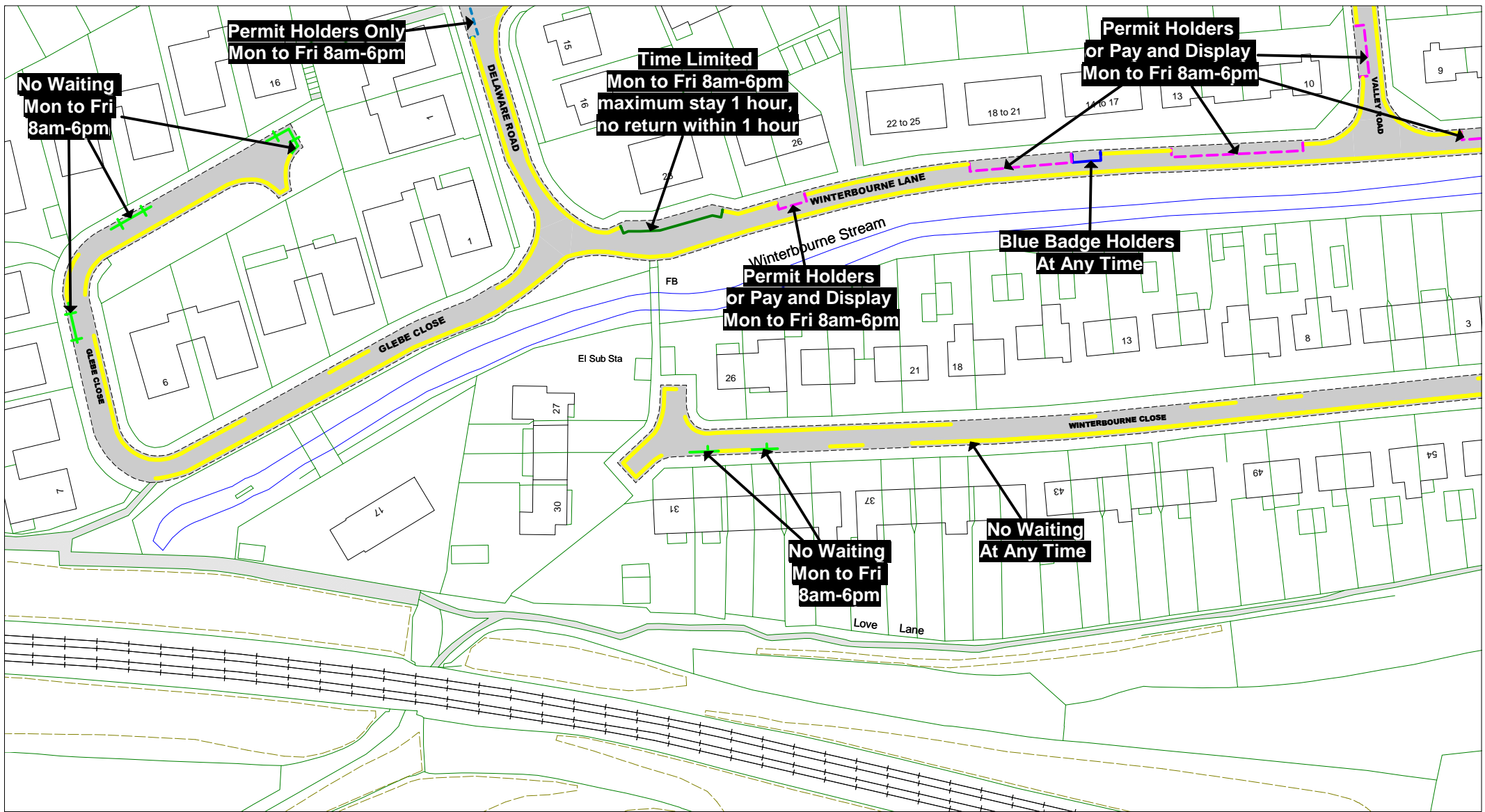

The East Sussex Lewes Town
(Parking Places and Waiting
and Loading Restrictions)
Traffic Regulation Order 2014
Amendment No.1 2016

Key to TRO Restriction Types

- No Waiting at Any Time
- + No Waiting
- + No Loading at Any Time
- + No Loading
- Pay and Display
- Permit Holders Only
- Permit Holder or Pay and Display
- Limited Waiting
- Disabled Badge Holders Only
- Car Club Permit Only
- Loading/ Unloading Only
- Motorcycles Only
- Taxi Only
- ~ No Stopping On Entrance Markings
- X Restricted Parking Zone No Waiting at Any Time

© Crown copyright. All rights reserved
East Sussex County Council
Licence No. 100019601 2016

Adjacent Map Tile

▲
LP103
← **LQ102**
LQ104 →
▼



SCALE	1 : 1000
DATE	23/09/2016
Tile Ref: LQ103	Revision: 1



**The East Sussex Lewes Town
(Parking Places and Waiting
and Loading Restrictions)
Traffic Regulation Order 2014
Amendment No.1 2016**

Key to TRO Restriction Types

- No Waiting at Any Time
- No Waiting
- No Loading at Any Time
- No Loading
- Pay and Display
- Permit Holders Only
- Permit Holder or Pay and Display
- Limited Waiting
- Disabled Badge Holders Only
- Car Club Permit Only
- Loading/ Unloading Only
- Motorcycles Only
- Taxi Only
- No Stopping On Entrance Markings
- Restricted Parking Zone No Waiting at Any Time

© Crown copyright. All rights reserved
East Sussex County Council
Licence No. 100019601 2016

Adjacent Map Tile

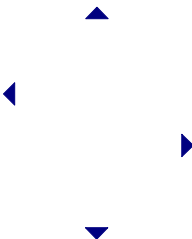

SCALE	1 : 1000
DATE	23/09/2016
Tile Ref: LS104	Revision: 0